

Installation



DD WOOD
ไม้บัวดีดุก

Crown Cornice

Remark: This installation is not suitable for 90 degree corner. If it is a 90 degree corner installation, it can be cut at 45 degrees.

Caution: Avoid sovents base as thinner. Cause wood pattern may be damaged.

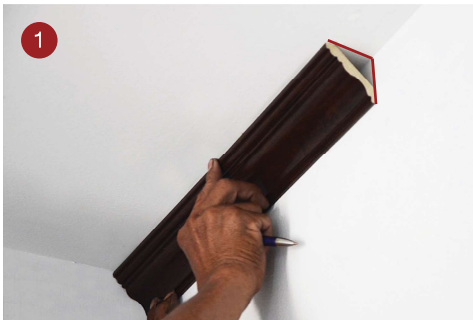

1 Place the cornice to fit the corner of the wall and ceiling.



2 Mark line at above cornice and below cornice



3 Mark line as the 2nd method in the next wall for getting the cutting point.

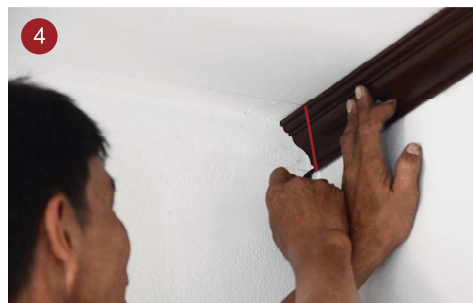

4 Mark line from the cutting point to corner of the wall as shown as picture.



5 Cut along the red line mark from 4th method



6 Place to the install area before put the glue.



7 Put the power nail glue on cornice.



8 Put the power nail gun instead of supporting the cornice on 3-5 minutes.



9 Put the power nail glue on the connecting point as shown as picture before installing the next cornice.