

Installation



DD WOOD
ไม้บัวดีดงู

Wall Cornice

Remark: This installation is not suitable for 90 degree corner. If it is a 90 degree corner installation, it can be cut at 45 degrees.

Caution: Avoid solvents base as thinner. Cause wood pattern may be damaged.



1 Measure the length that we need as shown as picture.



2 Cut according to the measured size

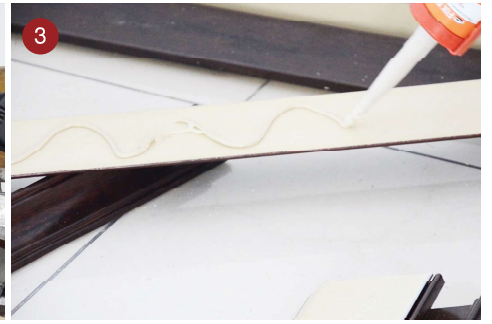

3 Put glue in the wave pattern.

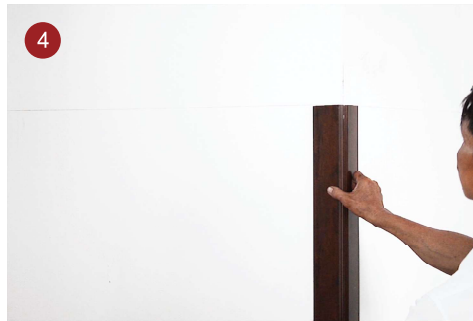

4 Start to install from the corner of wall as shown as the picture.



5 Install the wall cornice as shown as picture.

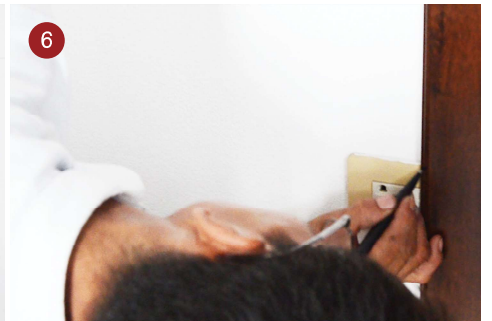

6 If we see the electric plug, we can mark as shown as the picture.



7 Can cut on the wood cover and be broken off. Use sandpaper to decorate.

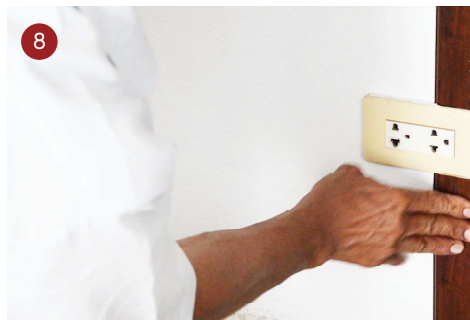

8 Put the power nail glue for installation.